



**Veria Control  
B35/B45**

Installation guide



# Table of content

<b>1 Introduction</b>	2
1.1 Technical Specifications	3
1.2 Safety instructions	5
<b>2 Mounting instructions</b>	6
<b>3 Settings</b>	10
3.1 Temperature settings	10
<b>4 Warranty</b>	12

---

## 1. Introduction

Veria Control B35/45 is a electronic thermostat provided with a 2-pole switch and a floor sensor to measure and control the desired floor temperature. The thermostat is intended for flush-mounting.

Veria Control is equipped with a LED indicator showing standby periods (green light) and heating periods (red light).

The maximum temperature setting of the **Veria Control B35** Thermostat is 35°C, which makes it ideal for controlling electrical heating mats beneath or on top of wood floors such as parquet or laminates.

The **Veria Control B45** Thermostat can be used for temperatures up to 45°C, which makes it ideal for controlling electrical heating mats on top of concrete or screed floors or underneath a tile or decorative stone covering.

## 1.1 Technical Specifications

Operating voltage	180-250 VAC, 50/60 Hz
Contact rating: - resistive load - inductive load	250V ~ 15A/3450W cos $\varphi$ = 0,3 Max. 4A
Sensor	NTC 15 kOhm at 25° C
Sensor values: 18° C 20° C 22° C	19,7 kOhm 18,0 kOhm 16,8 kOhm
Switching differential	$\pm 0,2^\circ$ C
Temperature range: - Veria Control B35 - Veria Control B45	(0) 15-35° C (0) 5-45° C
Ambient temperature range	-10° to +30° C
Frost protection (❄)	15° C (B35) / 5° C (B45)
Led Indicator: - No light - Red light - Green light  - Green light flashing	Thermostat off. Heating mat/cable is active The desired set point temperature has been reached. Floor sensor is faulty
Protection rating	IP 31
Dimensions & weight	85mm x 85mm & 90 g

## 1.1 Technical Specifications

Cable specification max.	1x4mm <sup>2</sup> or 2x2,5mm <sup>2</sup>
Ball pressure temperature	75°C
Pollution degree	2 (domestic use)
Type	1C
Storage temperature	-20 to +65°C
Protection class	Class II - 

The product complies with the EN/IEC Standard "Automatic electrical controls for household and similar use":

- EN/IEC 60730-1 (general)
- EN/IEC 60730-2-9 (thermostat)

### **Produced for:**

Veria ApS  
Ulvehavevej 61  
DK-7100 Vejle  
Denmark

Fax: +45 7488 7151

E-mail: mail@veria.dk

## 1.2 Safety Instructions

### 1. Safety Instructions

Make sure the mains supply to the thermostat is turned off before installation.

#### **IMPORTANT:**

When the thermostat is used to control a floor heating element in connection with a wooden floor or similar material, always use a floor sensor and never set the maximum floor temperature to more than 35°C.



*Please also note the following:*

- The installation of the thermostat must be done by an authorized and qualified installer according to local regulations.
- The thermostat must be connected to a power supply via an all-pole disconnection switch.
- The sensor is to be considered as live voltage. Have this in mind if the sensor must be extended.
- Always connect the thermostat to continuous power supply.
- Do not expose the thermostat to moisture, water, dust, and excessive heat.

## 2. Mounting Instructions

### 2. Mounting Instructions

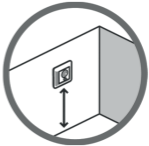
Please follow the below guidelines when installing the thermostat

<p>Place the thermostat at a suitable height on the wall (typically 80-170cm)</p>	
<p>In wet rooms, place the thermostat according to local regulation on IP classes.</p>	
<p>Plaats de thermostaat niet aan de binnenzijde van een buitenmuur.</p>	

## 2. Mounting Instructions

A floor sensor enables a more accurate temperature control and is recommended in all floor heating applications and mandatory under wooden floors to reduce the risk of over-heating the floor.

- Place the floor sensor in a conduit in an appropriate place where it is not exposed to sunlight or draft from door openings.
- Equally distant and  $>2\text{cm}$  from two heating cables.
- The conduit should be flush with the floor surface - countersink the conduit if necessary.
- Route the conduit to the connection box.
- The bending radius of the conduit must be min 50mm.

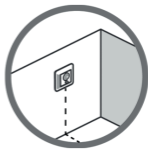

Avoid placing the thermostat in direct sunlight

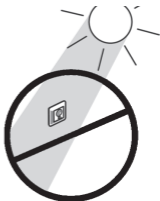

## 2. Mounting Instructions

Follow the steps below to mount the thermostat:

1. Open the thermostat:

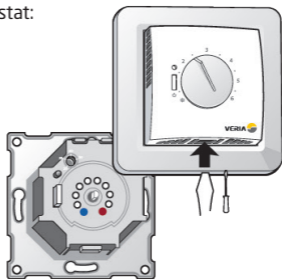

2. Connect the thermostat according to the below diagram.

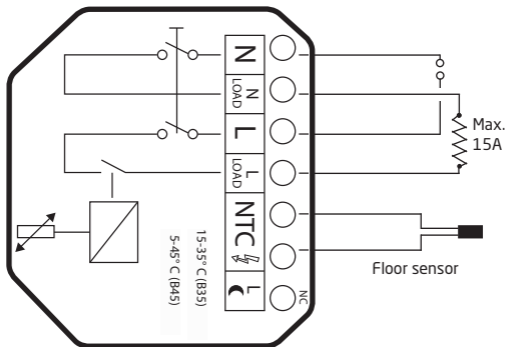



## 2. Mounting Instructions

The screen of the heating cable must be connected to the earth conductor of the power supply cable by using a separate connector.

Note: Always install the floor sensor in a conduit in the floor.

### 3. Mount and reassemble the thermostat.

- Fasten the thermostat to a socket or an exterior wall box by driving the screws through the holes in each side of the thermostat.
- Install the frame and front cover in the reverse order of disassembly.

### 4. Turn on the power supply.

## 3. Settings

### 3.1 Temperature settings

How to change the minimum and maximum floor temperatures

1. Remove the adjustment button.

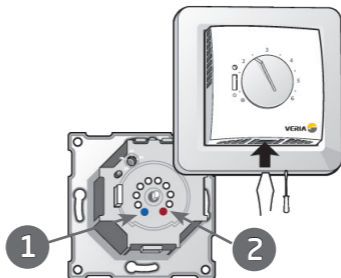

2. Move the pins to the desired positions. (1 en 2)

3. Put the adjustment button back in place.

**Note: Please be aware of the following:**

- The floor temperature is measured where the floor sensor is placed.
- The temperature of the bottom of a wooden floor can be up to 10 degrees higher than the top.
- Floor manufactures often specify the max temperature on the top surface of the floor (usually 27-28°C).
- Always use a floor sensor to control floor heating.

## 3. Settings

- Without a floor sensor, the temperature control may be less accurate and you risk overheating the floor.

## 4. Warranty

Veria products are designed for many years of trouble-free operation. Consequently, the Veria Quickmat and Veria Flexicable products are guaranteed for 12 years if installed properly in accordance with the Installation Guide.

All other Veria products, including the Veria Control B35/B45, have a two-year guarantee. This guarantee covers all products that are clearly defective due to a deficiency in manufacturing, design or material.

The guarantee is null and void in the following cases:

- If the product is not installed in accordance with the Installation Guide.
- If the product is not connected by an authorised electrician or electrical specialist.
- If the defect is caused by an unsuitable or poor floor construction.

In addition, guarantee claims will only be honoured if the attached guarantee certificate is completed properly. The owner must keep this certificate in a safe place and present it in case of a guarantee claim.

If for some reason a guarantee claim is necessary, we will repair the product at no charge or send you a replacement product at no charge.

The guarantee does not cover indirect or additional costs, such as the cost of determining the cause of the fault, removing the product, repairing the floor, etc.

## 4. Warranty

### Warranty certificate

Name:

Street address:

City/town and postcode:

Telephone:

**Note!**

You must complete the following questionnaire fully and accurately in order to make a guarantee claim.

Electrical installer:

Installation date:

Thermostat type:

Article code:

Stamp:

# Notes

---

---

---

---

---

---

---

---

---

---

---

# Notes

---

---

---

---

---

---

---

---

---

---

---

# Veria Control B45

## Analog Thermostat

---

Operating voltage: 230V~

Temperature range: +5°C - 45°C

Max. load: 15 A

Item number: 189B4050

---



5 703466 190401